



## 47 mm In-Line Polycarbonate Filter Holder

- Remove submicron particles from continuously flowing liquid or gas systems
- Suitable for contamination analysis of particulate
- Lightweight, durable design is transparent to allow easy visual check of membrane surface

### Ordering Information

Prod. No.	Description	Packaging
1119	47 mm In-line Polycarbonate Filter Holder	1/pkg

### Specifications

#### Materials of Construction

Inlet Cover, Outlet Base: Polycarbonate  
Support Screen: Polyphenylsulfone  
O-ring: Silicone  
Hose Barb Adapters: Nylon  
Vent Cap: Polypropylene

#### Effective Filtration Area

9.6 cm<sup>2</sup> (1.5 in.<sup>2</sup>)

#### Dimensions

Diameter: 6.4 cm (2.5 in.)  
Overall Length: 5.6 cm (2.2 in.), excludes Hose Barb Adapters, includes vent cap

#### Inlet/Outlet Connections

1/4 in. – 18 FNPT; Hose Barb Adapters accept 6.4 mm (1/4 in.) ID tubing

#### Maximum Operating Pressure

3.4 bar (340 kPa, 50 psi)

#### Maximum Operating Temperature

Limited by membrane filter type, Hose Barb Adapter 121 °C (250 °F), or O-ring 204 °C (399 °F), which ever is lowest.

#### Sterilization

Provided non-sterile; autoclavable if desired at 121 – 123 °C (250 – 253 °F) at 1.0 bar (100 kPa, 15 psi) for 15 – 20 minutes.

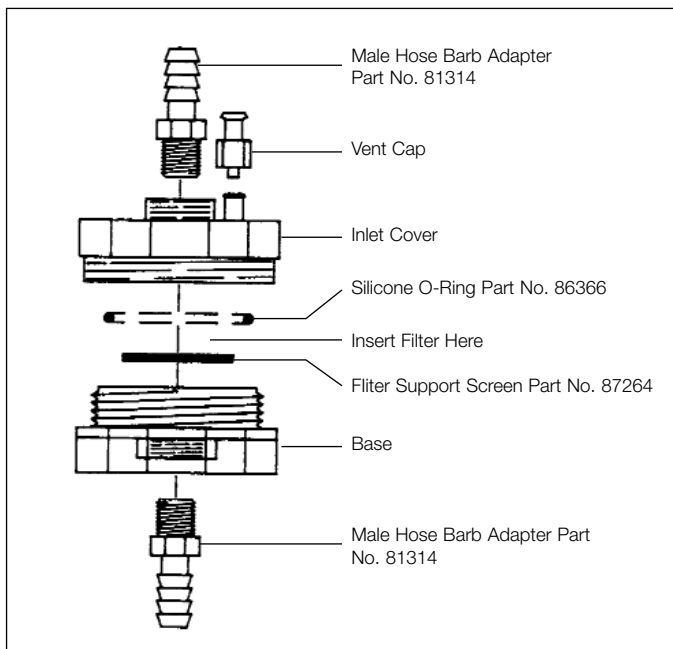

### Instructions for Use

1. Place support screen firmly into base.
2. Place filter on top of support screen.
3. Place O-ring on top of filter.
4. Holding base level, place inlet cover onto base and hand tighten the unit.
5. Tighten adapters just until secure using a wrench on the hex nut portion of the inlet/outlet adapter. Avoid over-tightening.



---

## Instructions for Use (cont.)

### Cleaning and autoclaving instructions

1. Disassemble unit into component parts.
2. Clean with a non-abrasive cleanser.
3. Rinse thoroughly.
4. Allow to air dry.
5. If autoclaving is required, reassemble unit, adapters and vent cap loosely with or without the filter in place. Wrap the unit in autoclave paper and autoclave under standard conditions listed under Specifications section. Check specifications of the filter being used for any additional autoclave recommendations and maximum operating temperature.
6. Before use, be sure to tighten unit, adapters and vent cap adapters as described in Instructions for Use above.

---

## WARNING

**Employment of the products in applications not specified, or failure to follow all instructions contained in this product information insert, may result in improper functioning of the product, personal injury, or damage to property or the product. See Statement of Warranty in our most recent catalog.**

---

## ATTENTION

**L'utilisation de nos produits dans des applications pour lesquelles ils ne sont pas spécifiés ou le non-respect du mode d'emploi qui figure sur ce document, peut entraîner un dysfonctionnement du produit, endommager le produit ou d'autres biens matériels ou représenter un risque pour l'utilisateur. Se référer à la clause de garantie de notre catalogue le plus récent.**

---

## ACHTUNG

**Der Einsatz dieses Produktes in Anwendungen für die es nicht spezifiziert ist, oder das Nichtbeachten einiger, in dieser Bedienungsanleitung gegebenen Hinweise kann zu einem schlechteren Ergebnis, oder Zerstörung des Produktes oder anderer Dinge oder gar zu Verletzungen führen. Beachten Sie auch unsere Garantiebedingungen im aktuellen Katalog.**

---

## ADVERTENCIA

**El uso de este producto en aplicaciones no especificadas o el no considerar las instrucciones indicadas en la hoja de información del producto puede ocasionar un mal funcionamiento del producto, daños en las instalaciones o en el producto y riesgo para el personal del laboratorio. Consulte el apartado de Garantía en nuestro último catálogo.**

---

## ATTENZIONE

**L'impiego dei prodotti in applicazioni non specificate, o il mancato rispetto di tutte le istruzioni contenute nel presente bollettino tecnico, potrebbero portare ad un utilizzo improprio del prodotto, ferire gli operatori, o danneggiare le caratteristiche del prodotto stesso. Consultare la dichiarazione di garanzia pubblicata nel nostro più recente catalogo.**

---

## 警告

当製品情報に記載されていないアプリケーションにおいて製品を使用した場合、あるいは当製品情報に記載されている使用方法に従わない場合は、製品の機能上の不具合、人体への危害、あるいはお客様の財産や製品への損害をまねく恐れがあります。必ず、最新のカatalogに記載してある保証約款をご覧ください。

### Pall Life Sciences

600 South Wagner Road  
Ann Arbor, MI 48103-9019 USA

For ordering or technical information:  
Tel: 734-665-0651  
800-521-1520 (in USA)  
Fax: 734-913-6114

Visit Pall Life Sciences on the  
Internet: [www.pall.com/Lab](http://www.pall.com/Lab) or  
e-mail us at: [Lab@pall.com](mailto:Lab@pall.com)

### Offices:

**Australia**, Lane Cove, NSW, 02-9428 2333  
**Austria**, Wien, 043-1-49 192 0  
**Canada**, Ontario, 905-542-0330  
**Canada**, Québec, 514-332-7255  
**China**, P.R., Beijing, 86-10-8458 4010  
**France**, St. Germain-en-Laye, 01 30 61 39 92  
**Germany**, Dreieich, 06103-307 333  
**India**, Mumbai, 91-22-5956050  
**Italy**, Milano, 02-47-79-61  
**Japan**, Tokyo, 3-3495-8319  
**Korea**, Seoul, 2-569-9161  
**Poland**, Warszawa, (+ 48 22) 510 21 00  
**Russia**, Moscow, 095 787-76-14  
**Singapore**, 65-389-6500  
**Spain**, Madrid, 91-657-9876  
**Sweden**, Lund, 46-0-46 15 84 00  
**Switzerland**, Basel, 061-638 39 00  
**Taiwan**, Taipei, 2-2545-5991  
**United Kingdom**, Portsmouth, 023 92 302600