

Point-of-Use Water Filters

Pall-Aquasafe™

Product Tender Text (Not for use or distribution in the USA)

Point-of-Use Water Filters for Taps for patient protection



Water Filter: AQ31F1S



Quick Connect Adapter: TAP22FV

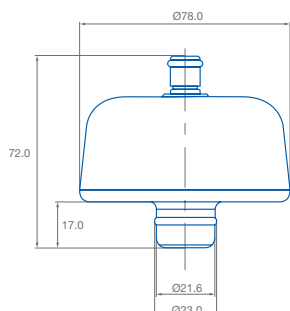

Schematic drawing: AQ31F1S

- ▶ Disposable Water Filters validated for up to 31 day use
- ▶ **CE marked medical device**
- ▶ **Membrane area (nominal):** Approx. 550 cm²
- ▶ **Size / length:** Approx. 72 mm (without Quick Connect Adapter)
- ▶ **Filtration media:** 0.2 µm double layer sterilising grade membrane Supor® with integrated pre-filtration layer (approx 1.0 µm) validated according to ASTM F838-05
- ▶ **Certifications:** National water regulatory authority compliance
- ▶ **Bacteriostatic additive:** To minimise risk of inadvertent retrograde contamination. Additive validated according to ISO 22196
- ▶ **Pressure and temperature compatibility:** Continuous use at up to 60 °C at 5 bar (approximately 75 psi) inlet pressure
- ▶ **Thermal shock treatment:** Exposure at 70 °C for a total cumulative period of 30 minutes over the lifetime of the filter at up to 5 bar (approximately 75 psi) inlet pressure
- ▶ **Flow rates (nominal):** 5.3 – 17.3 L/min (at 1-5 bar)
- ▶ **Back contamination:** Data available to support no increased back contamination risk upstream of the filter, e.g. in drinking water installation
- ▶ **Shock treatment with pH > 12 (NaOH):** Compatible with sodium hydroxide (NaOH) solutions (pH 12.8) for up to 1 hour at ambient temperature
- ▶ **Shock treatment with active chlorine (Cl₂):** Compatible with 100 ppm Cl₂ for up to 1 hour at ambient temperature
- ▶ **Continuous treatment with active chlorine (Cl₂):** Compatible with Cl₂: < 7 ppm at 30 °C over the filter's indicated lifetime followed by Cl₂ shock treatment with 100 ppm for up to 1 hour at ambient temperature
- ▶ **Treatment with chlorine dioxide (ClO₂):** Compatible with continuous ClO₂ treatment at 1 mg/L and ClO₂ shock treatment with 100 mg/L for 12 hours
- ▶ **Shock treatment with peracetic acid (C₂H₄O₃):** Compatible with 1000 ppm C₂H₄O₃ at 60 °C for 2 hours
- ▶ Do not attempt to resterilise or reprocess
- ▶ Individually integrity tested during manufacturing
- ▶ Provided sterile. Sterilised by irradiation
- ▶ Easy installation using Quick Connect Adapters (Accessories)

Product	Reorder Code	Description
Pall-Aquasafe™ Water Filter for Taps	AQ31F1S	Point-of-Use Water Filter for Taps for patient protection
Accessories		
Quick Connect Adapter	TAP21MV	21 mm male thread, with valve
Quick Connect Adapter	TAP21MN	21 mm male thread, without valve
Quick Connect Adapter	TAP22FV	22 mm female thread, with valve
Quick Connect Adapter	TAP22FN	22 mm female thread, without valve
Quick Connect Adapter	TAP24MV	24 mm male thread, with valve
Quick Connect Adapter	TAP24MN	24 mm male thread, without valve
Quick Connect Adapter	TAP1/2MV	½ inch male thread, with valve
Quick Connect Adapter	TAP1/2MN	½ inch male thread, without valve
Quick Connect Adapter	TAP1/2FV	½ inch female thread, with valve
Quick Connect Adapter	TAP1/2FN	½ inch female thread, without valve