

# Gaskleen® 6101 Series Filter Assembly (1.5 nm)



Data Sheet MEGK61ENa

## Description

The Gaskleen® 6101 Series Filter Assembly is designed for  $\geq 1.5$  nanometer (0.0015  $\mu\text{m}$ ) filtration of process gases.

## Features & Benefits

- 316L stainless steel electropolished housing
- Emflon® PTFE element
- Available in both standard and shortened version
- Wide variety of fitting options available
- Compact size (2.2"/56mm dia.) for ease of installation
- 100% integrity tested
- Cleanroom manufactured and packaged
- 100% helium leak tested



## Specifications

Filter Medium	PTFE
Core and End Caps	Polypropylene
O-ring	FEP encapsulated fluoroelastomer
Internal Surface Finish	25 $\mu\text{in}$ / 0.64 $\mu\text{m}$ R <sub>a</sub>
Housing	Electropolished 316L stainless steel
Removal Rating	$\geq 1.5$ nm
Filter Area	$< 464$ cm <sup>2</sup> / 0.5 ft <sup>2</sup>
Connections	1/4" Gasket Seal, Male (VCR <sup>1</sup> or compatible)
	1/4" Compression Seal (Swagelok <sup>1</sup> or compatible)
	3/8" Gasket Seal, Male (VCR or compatible)
	3/8" Compression Seal (Swagelok or compatible)
	1/4" Female pipe thread

Leak Rating	100% helium leak tested to $10^{-7}$ atm·cm <sup>3</sup> /s
	Design validated to $10^{-9}$ atm·cm <sup>3</sup> /s
Maximum Operating Pressure	750 psig @ 176 °F / 52 bar @ 80 °C
Maximum Forward Differential Pressure	100 psid @ 70 °F / 7 bar @ 21 °C
Maximum Reverse Differential Pressure	50 psid @ 70 °F / 3.4 bar @ 21 °C
Packaging	Double bagged
	Outer bag: aluminized mylar
	Inner bag: polyethylene
EU Pressure Equipment Directive	N <sub>2</sub> purged
	Assemblies have been evaluated and designed using SEP per the European Union's Pressure Equipment Directive 2014/68/EU and are not CE marked.

<sup>1</sup> VCR and Swagelok are trademarks of Swagelok Co.

## Pressure Drop vs. Gas Flow Rate

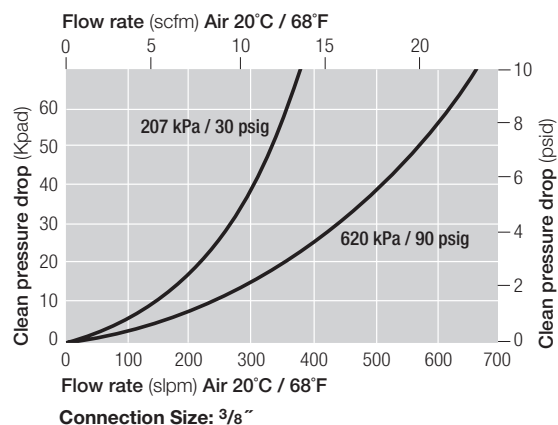
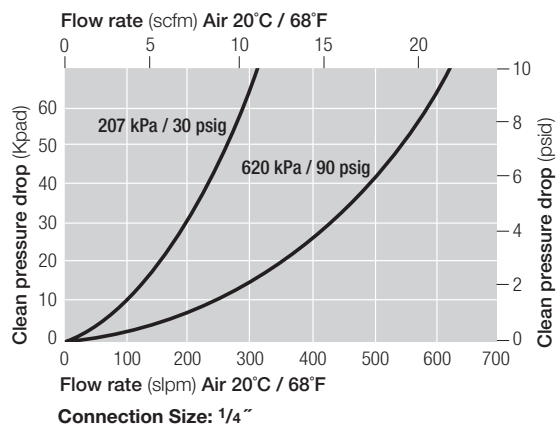

## Dimensions

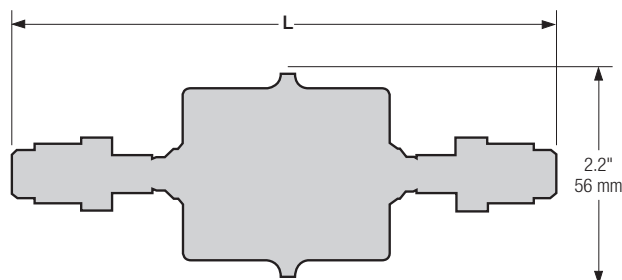

## Part Numbers / Ordering Information

Part Number	Description	Length (L) (in / mm)
GLF6101VM4	Gaskleen, 1/4" Gasket Seal (VCR or Compatible) Male / Male	5.56 / 141
GLF6101VM6/8	Gaskleen, 3/8" or 1/2" Gasket Seal (VCR or Compatible) Male / Male	5.81 / 148
GLF6101VFM4	Gaskleen, 1/4" Gasket Seal (VCR or Compatible) Female / Male	5.81 / 148
GLF6101SM4S	Gaskleen, 1/4" Compression Seal (Swagelok or Compatible) Male / Male	5.56 / 141
GLF6101SM6S	Gaskleen, 3/8" Compression Seal (Swagelok or Compatible) Male / Male	5.81 / 147
GLF6101SM8	Gaskleen, 1/2" Compression Seal (Swagelok or Compatible) Male / Male	4.38 / 111
GLF6101FP4	Gaskleen, 1/4" Female NPT	5.19 / 132
SGLF6101VM4M	Short Gaskleen, 1/4" Gasket Seal (VCR or Compatible) Male / Male	5.00 / 127
SGLF6101VM4	Short Gaskleen, 1/4" Gasket Seal (VCR or Compatible) Male / Male	4.94 / 126
SGLF6101VM6/8M	Short Gaskleen, 3/8" or 1/2" Gasket Seal (VCR or Compatible) Male / Male	5.00 / 127
SGLF6101SM4S	Short Gaskleen, 1/4" Compression Seal (Swagelok or Compatible) Male / Male	4.19 / 106
SGLF6101SM6S	Short Gaskleen, 3/8" Compression Seal (Swagelok or Compatible) Male / Male	5.00 / 127

Unit conversion: 1 bar = 100 kilopascals



### Microelectronics

25 Harbor Park Drive  
Port Washington, NY 11050  
+1 516 484 3600 telephone  
+1 800 360 7255 toll free US

### Nihon Pall Ltd.

6-5-1, Nishishinjuku,  
Shinjuku-ku  
Tokyo 163-1325 Japan  
+81 3 6901 5700 telephone  
+81 3 5322 2109 fax

Pall Corporation has offices and plants throughout the world. To locate the Pall office or distributor nearest you, visit [www.pall.com/contact](http://www.pall.com/contact).

The information provided in this literature was reviewed for accuracy at the time of publication. Product data may be subject to change without notice. For current information consult your local Pall distributor or contact Pall directly.

IF APPLICABLE Please contact Pall Corporation to verify that the product conforms to your national legislation and/or regional regulatory requirements for water and food contact use.

© Copyright 2025, Pall Corporation. Pall, , and Gaskleen are trademarks of Pall Corporation.® Indicates a trademark registered in the USA.

